



Instructions for pairing Ultra Secua with additional door



DOWNLOAD & INSTALL



Download and Install the McGrath Locks APP
Enable your smart phone to scan QR code to download the APP. Also you can search "McGrath Locks" on Apple store or Google play to download the APP.

THE ULTRA SECUA LOCK IS ADDED INTO THE MAIN DOOR AS A "REMOTE" THROUGH THE MCGRATH LOCKS APP.

Note: Both Locks need to be registered in the App and Admin Code for Ultra Secua must be known.

1. Open the McGrath Locks App and enter the main door lock menu, Click "Remote".

2. Press "+ Add remote".

3. Choose permanent and name the remote ("Screen door" is a great name). Click 'Next'.

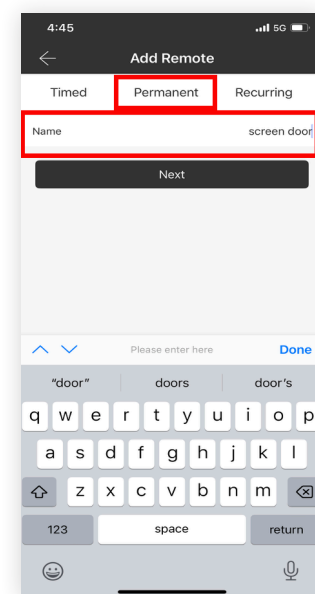
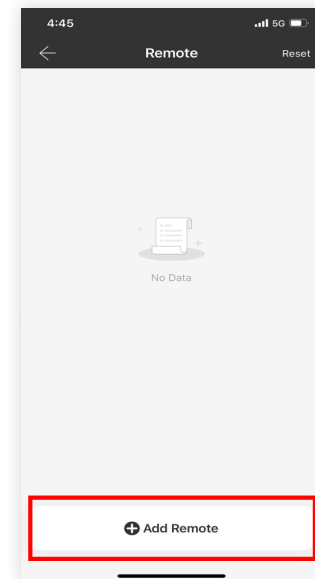

mcgrathlocks.com.au

4. Choose 'R1' and wake Ultra Secua by pressing on the keypad.

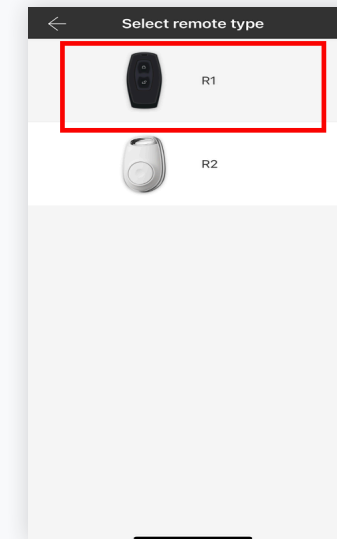

5. When prompted with the screen below. Go to the keypad of the Ultra Secua and press * 8 1 3 #--admin code # 1 #
The Ultra Secua will say "Operation successful". Then click "Next"

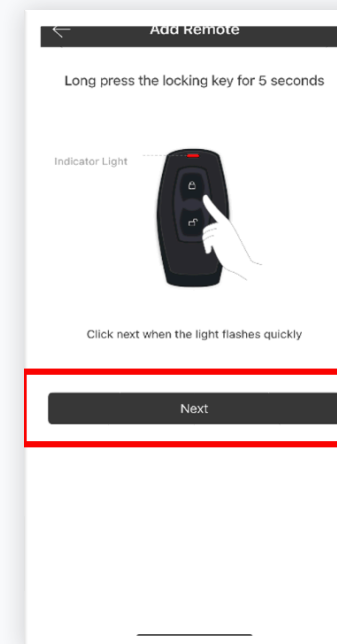
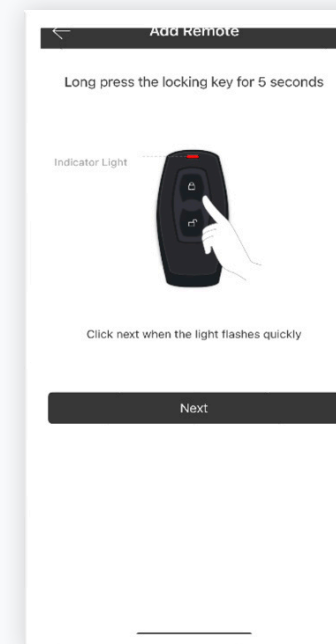

mcgrathlocks.com.au

6. You will see the Ultra Secua remote. Press on the '+' button.

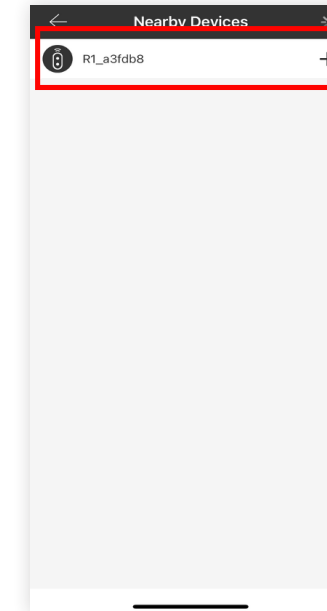

7.) The Ultra Secua has now successfully been learnt into the door.

Now when you open your Ultra Secua the internal door will also open.

Tip: Go into the McGrath Locks App and Select the main door lock, go to settings and "Auto Lock" and extend the open time to 10 seconds or greater.

mcgrathlocks.com.au

